

KentuckyWMU



DO *justly*
LOVE *mercy*
WALK *humbly*

MICAH 6:8



Missions Celebration
& ANNUAL MEETING

APRIL 8-9, 2022
HODGENVILLE, KY
KYWMU.ORG

engage in
God's Mission



Kentucky
WMU

TABLE OF *Contents*

MISSIONS CELEBRATION

WELCOME LETTER OF GREETING FROM KY WMU	4
WEEKEND SCHEDULE & CAMPUS MAP	5
GENERAL SESSION 1	6
GENERAL SESSION 2	7
GENERAL SESSION 3	8
WORKSHOPS & DESCRIPTIONS	9
WORKSHOP SCHEDULE	11
FEATURED GUESTS & WORKSHOP LEADERS	13
MISSIONARY PRAYER CALENDAR	16
SUPPORTING OUR MISSIONARIES	17
THANK YOU FROM OUR MISSIONARIES	18
KBC MISSIONARY COMMISSIONING	19
KBC MISSIONARY OF THE YEAR	20

ANNUAL MEETING

VOTING INFORMATION	24
MINUTES OF THE APRIL 17-18, 2021 ANNUAL MEETING RECOMMENDATION FORM	26

GENERAL

THANK YOU	22
ANNOUNCEMENTS	23
HEALTH & SAFETY	23
EXPERIENCES	23
THE MARKETPLACE: MINISTRY PARTNERS	15



Welcome TO HODGENVILLE

We personally welcome each of you to the 2022 Kentucky WMU Annual Meeting and Missions Celebration! It is an exciting time for Kentucky WMU as we fulfill the call of God for missions for the organization and continue to remain adaptable, motivated, and responsive to the changes of our world today. We thank local arrangements committee chair, Donna Nolley, and the First Baptist Church Hodgenville staff and volunteers for their warm Kentucky hospitality in hosting our event this weekend.

This year, we will explore the theme **Do, Love, Walk**, based on Micah 6:8 (NIV). God's plan for missions began long before the early church. A simple question to the prophet Micah lays out God's plan for how believers should live their lives, and what is required of them but to "do justly, to love mercy, and walk humbly with your God." Notice that the text reads not as a suggestion but as what is expected of every believer and to each participant of Kentucky WMU. Will we commit to the Lord's desire for our lives? If so, we must be intentional in walking in His ways, sharing His hope, and stressing Gospel urgency.

This year, we are excited to welcome several dynamic general session speakers that will share messages of encouragement and stories of their journey walking with the Lord. You will also experience a variety of workshop session facilitators who have been given the challenging assignment of sharing practical ways to engage in missions locally and abroad. It is our prayer that you will leave equipped with new ideas for engaging in God's mission, encouraged to build relationships that are intergenerational and multicultural, and emboldened to make disciples who make disciples.

Laborers Together!



Liz Encinia
Executive Director-Treasurer
Kentucky WMU



Roetta Vaught
President
Kentucky WMU

WEEKEND

Schedule

FRIDAY | APRIL 8

10:00 am Registration Opens

*Marketplace, Hands-on Ministry,
Prayer Experience Open*

Lunch on Your Own

1:00 pm Opening General Session

2:45 pm Conference Session 1

4:00 pm Conference Session 2

5:00 pm **Dinner (on your own)**

7:00 pm General Session

8:30 pm Reception to Celebrate outgoing
President, Roetta Vaught

SATURDAY | APRIL 9

8:30 am Conferences Session 3

9:45 am Conferences Session 4

11:00 am Closing General Session

CAMPUS
Map

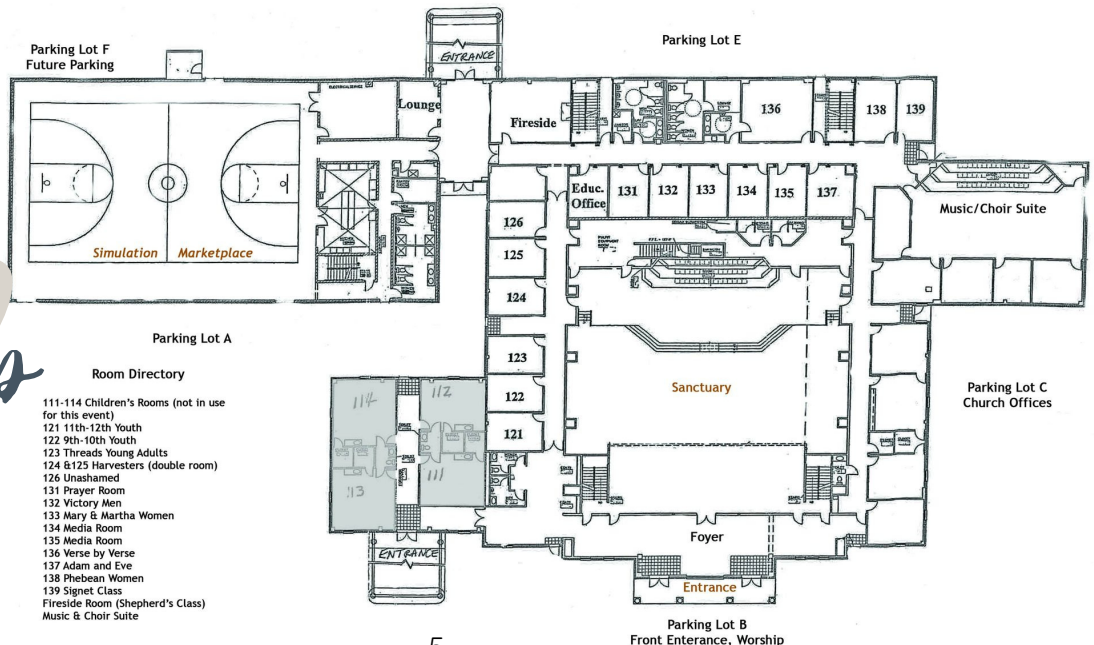

GENERAL *Session 1*

APRIL 8 | 1:00PM

MCS: ROETTA VAUGHT, LIZ ENCINIA

Opening Worship	Lauren Payne & Reagan Brown
Welcome & Prayer	Roetta Vaught & Liz Encinia
Worship	Lauren Payne & Reagan Brown
Acknowledgements	
Sharing Jesus in the Appalachian Mountains	Rob Allen
Prayer for Missionaries	Stacy Nall
Offering to Ministries to Missionaries	
Sharing Jesus with Deaf Peoples in Mexico	Gary & Sis Tufts
Theme Interpretation: Do Justly	Sandy Wisdom-Martin

Notes

PLEASE REMEMBER TO SILENCE CELL PHONES DURING ALL GENERAL SESSIONS AND
CONFERENCES. THANK YOU

GENERAL *Session 2*

APRIL 8 | 7:00PM
MCS: LIZ ENCINIA

Worship	Lauren Payne & Reagan Brown
Sharing Jesus with At-risk Women in Paducah	Lee Rust
KY MSC Commissioning	Eric Allen, Teresa Parrett
2022 Missionary of the Year	
Sharing Jesus in Africa	R & L
Worship	Lauren Payne & Reagan Brown
Theme Interpretation: Love Mercy	Sandy Wisdom-Martin

Notes

PLEASE REMEMBER TO SILENCE CELL PHONES DURING ALL GENERAL SESSIONS AND
CONFERENCES. THANK YOU

GENERAL Session 3

APRIL 9 | 11:00AM
MCS: ROETTA VAUGHT

Opening of Business 119th Annual Meeting	Roetta Vaught, President
<ul style="list-style-type: none">• Approval of the Minutes• Nominating Report• Election of 2022-2023 Officers & Board• Prayer for Dedication• EDT & President's Report	Claudia Greenwood Roetta Vaught Sandy Wisdom-Martin Liz Encinia, Roetta Vaught
President's Closing of the Business Session	Roetta Vaught
Prayer for Missionaries & Offering	Lori Sharp
Worship	Lauren Payne & Reagan Brown
Special Presentation	Pat Callan
Project HELP & Critical Issues	Liz Encinia
<ul style="list-style-type: none">• Panel Discussion	Jon Barnett, Peggy Meriedeth
Worship	Lauren Payne & Reagan Brown
Theme Interpretation:	
Walk Humbly with your God	Sandy Wisdom-Martin
Closing Words	Roetta Vaught
<ul style="list-style-type: none">• Invitation to 2023 Annual Meeting• Closing Prayer	Liz Encinia New President

Notes

PLEASE REMEMBER TO SILENCE CELL PHONES DURING ALL GENERAL SESSIONS AND CONFERENCES. THANK YOU

Workshop

DESCRIPTIONS

THESE CONFERENCE WORKSHOPS ARE TO CHALLENGE US TO DO, LOVE, AND WALK ON MISSION WITH OUR LORD!

THREE CIRCLES BY ANDY MCDONALD

"I want to be more faithful in sharing the Good News with others, but I struggle with feeling confident in the task." If this statement describes you, the Three Circles workshop is the place to be! During this workshop, you will learn a simple way to turn everyday conversations into Gospel conversations using the Three Circles.

LEADING CHURCHES TO REACH OUT THROUGH MISSIONS ENGAGEMENT BY JON AUTEN

There are lost people all around us who have spiritual and practical needs. Learn about the WMU missions engagement opportunities that will help your church reach the lost for Christ.

SHARING JESUS AS YOU GO BY DAWN REED

Proverbs 3:6 tells us if we acknowledge the Lord, He will direct our paths. We can share Jesus along the way!

HOW LOST ARE THEY? BY GARY AND SIS TUFTS

There are an estimated 72 million Deaf People globally. The overwhelming majority have no access to scriptures, a church or someone who can share the Gospel with them. What can we do?

SOUL CARE BY SANDY WISDOM-MARTIN

Stephen Smith says soul care is "making space for what matters most." In this workshop, we will explore reconnecting with God and/or going deeper with Him.

GOSPEL CONVERSATIONS IN EVERYDAY LIFE BY JOB JUAREZ

Eating, playing, resting. How to have Gospel conversations with your neighbors.

MUSLIM PRAYER TEA BY CHARITY TAYLOR

Experience a Muslim Tea and learn how to engage Muslim women in your community through hospitality.

RISKY BUSINESS BY LEE RUST, FREEDOM FOREVER MINISTRIES, PADUCAH KY

Let's explore the complexities that create the at-risk woman and how she can be helped. Over two decades of data and interpersonal work with females, both imprisoned and released, has shown a common thread. This workshop strives to open eyes and hearts to reveal the root of the problem.

DISCIPLING THE WHOLE PERSON BY CASSIE COUCH

The Great Commission is clear. As we go throughout our lives, we should be making disciples. What are the inverse implications for seeking out discipleship for ourselves? Our society encourages shallowness. But we are meant to live deep lives in Christ, pursuing Him with our whole self: heart, mind, soul, and strength. Come and join us as we discuss how we can seek out discipling our whole person.

DISCIPLING HER: A GUIDE TO SHAPING AND PASSING ON A HEART AND PASSION FOR MISSIONS BY PENNY AKERS AND CASSIE COUCH

This workshop is designed for women who desire to be Titus 2 women with a passion for the Great Commission. Join us as we inspire each other to pass down the legacy of WMU by stirring a love of missions and mission action in the hearts of children, youth, and younger women.

Workshop

DESCRIPTIONS

THESE CONFERENCE WORKSHOPS ARE TO CHALLENGE US TO DO, LOVE, AND WALK ON MISSION WITH OUR LORD!

VISION FOR MISSIONS GIVING BY LIZ ENCINIA

When we are called as givers who sow into the expansion of God's kingdom, we need to do it generously, intentionally, and wisely. Come learn best practices to encourage your church to steward and manage their resources for the glory of God and for the sake of seeing the nations reached.

RELATIONSHIPS BY DARCY JO PORTER

Sometimes it's so easy to get caught up in the work of ministry that we forget the purpose of ministry: relationships. Our relationships with God and our relationships with each other are the defining aspects of our faith. But what does this look like practically? How do we intentionally foster things like cross-generational relationships while we do the work of ministry? Join us and find out.

MISSION KENTUCKY BY SUSAN BRYANT AND DAWNA CLARK

Join us for brainstorming and barnstorming Kentucky missions and leave with a birds-eye view of EBO (Eliza Broadus Offering) at work in Kentucky!

COMPASSION MINISTRY BY ROB ALLEN OF SEND RELIEF

What is it? How much do I really care?

"MASTER THOU CALLEST" BY JEFF WALLACE

Practicing the presence of God through all seasons of life. Exalt Christ. Make disciples. Pass the torch.

EMBRACING THE NATIONS AS OUR NEIGHBOR BY JOHN BARNETT

We live in an incredibly unique time to fulfill the Great Commission. In the midst of a global crisis, God is opening new pathways for the church to share the gospel, make disciples, and build community among the least reached peoples of the world both locally and globally. By answering 4 key questions, learn how you and your church can start reaching the nations next door.

BIBLE TRANSLATION AMONG THE BERBERS OF NORTH AFRICA BY ROB AND LYNN

Come and learn how the Bible is being translated translation in North Africa and see how computers are greatly assisting the process. We will take Q & A.

READY CHURCH BY MARK SICKLING

READY CHURCH is a strategy and tool to aid churches to prepare, connect, and respond in times of crisis and disaster. This strategy plan will give churches the ideas, tools, and direction to respond effectively and in a timely manner to assist their community when disasters happen.

FAMILIES ON MISSION BY STACY NALL

Find ways to do hands-on missions and ministry with your whole family! We'll share ideas and learn how to plan a family mini-mission trip.

LIFE-CHANGING PRAYER STRATEGIES FOR MY CHURCH BY TARYN BLOCKER

Find out how to cultivate individual and corporate prayer practices in your church in order to join God's kingdom work in your church, community, and beyond.

SNEAK PEAK AT WMU 2022-23 RESOURCES BY DENISE GARDNER

Find out about the new WMU Emphasis, ProjectHelp, curriculum, and more!

Workshop SCHEDULE

	2:45 PM Fri	4:00 PM Fri	8:30 AM Sat	9:45 AM Sat
121	Three Circles (D&T) - Andy McDonald	Three Circles (D&T) - Andy McDonald	Discussion Room	Discussion Room
122		4:30-6:00 Missionary Parent Fellowship (invitation only)	Families on Mission (D&T) Stacy Nall	Families on Mission (D&T) Stacy Nall
123	Discussion Room	Discussion Room	Discussion Room	Discussion Room
124- 125	Leading Churches to Reach Out through Missions Engagement (D&T) Jon Auten	Leading Churches to Reach Out through Missions Engagement (D&T) Jon Auten	Embracing the Nations as Our Neighbor (D&T) John Barnett	Embracing the Nations as Our Neighbor (D&T) John Barnett
126	Sharing Jesus as You Go (D&T) Dawn Reed	Sharing Jesus as You Go (D&T) Dawn Reed	Life-Changing Prayer Strategies for My Church (Prayer) Taryn Blocker	Life-Changing Prayer Strategies for My Church (Prayer) Taryn Blocker
Music Suite	How Lost Are They? (learn) Gary & Sis Tufts	How Lost Are They? (learn) Gary & Sis Tufts	Bible Translation Among the Berbers of North Africa (learn) R&L	Bible Translation Among the Berbers of North Africa (learn) R&L
Fire- side Room	Soul Care (prayer) Sandy Wisdom-Martin	Soul Care (prayer) Sandy Wisdom-Martin	Risky Business (learn) Lee Rust	Risky Business (learn) Lee Rust
131	Prayer Experience	Prayer Experience	Prayer Experience	Prayer Experience
132	Gospel Conversations in Everyday Life (D&T) Job Juarez	Gospel Conversations in Everyday Life (D&T) Job Juarez	Ready Church (S&G)Mark Sickling	Ready Church (S&G)Mark Sickling
133	Muslim Prayer Tea (prayer) Charity Taylor	Muslim Prayer Tea (prayer) Charity Taylor	Muslim Prayer Tea (prayer) Charity Taylor	Muslim Prayer Tea (prayer) Charity Taylor

Workshop SCHEDULE

	2:45 PM Fri	4:00 PM Fri	8:30 AM Sat	9:45 AM Sat
136	Relationships (S&G) Darcy Jo Porter	Vision for Missions Giving (S&G) Liz Encinia	Vision for Missions Giving(S&G) Liz Encinia	Relationships (S&G) Darcy Jo Porter
137	Mission Kentucky(S&G) Susan Bryant & Dawna Clark	Sneak Peak at 2022- 23 WMU Resources(learn) Denise Gardner	Mission Kentucky(S&G) Susan Bryant &Dawna Clark	Sneak Peak at 2022- 23 WMU Resources (learn) Denise Gardner
138	Compassion Ministry (S&G) Rob Allen	"Master Thou Callest" (learn) Jeff Wallace	Compassion Ministry (S&G) Rob Allen	"Master Thou Callest" (learn) Jeff Wallace
139	Discipling the Whole Person (Learn) Cassie Couch	Discussion Room	Discipling Her(S&G) Penny Akers &Cassie Couch	Discipling Her(S&G) Penny Akers & Cassie Couch

MY WORKSHOP CHOICES

SESSION 1 -

SESSION 2 -

SESSION 3 -

SESSION 4 -

Don't forget, The Marketplace is open during the conference sessions. If you don't make it in time for your conference, check out the ministry experiences in The Marketplace.

FEATURED *Guests*

ROB ALLEN

NAMB Send Relief, Appalachia Ministry
Center, Ashland, KY



LAUREN PAYNE & REAGAN BROWN

Worship Leader, Bellevue Baptist Church,
Owensboro, KY



DR. LIZ ENCINIA

Executive Director-Treasurer, Kentucky
WMU, Louisville, KY



SANDY WISDOM-MARTIN

Executive Director-Treasurer, WMU, SBC.,
Birmingham, AL



ROETTA VAUGHT

President, Kentucky WMU, Somerset, KY



LEE RUST

KY MSC Missionary, Freedom Forever
Ministries, Paducah, KY



FEATURED *Guests* (CONTINUED)

GARY & SIS TUFTS - Deaf Affinity, International Mission Board, Indiana

R & L - International Mission Board, Africa

DONNA NOLLEY - Chair Local Arrangements Committee, First Baptist Church, Hodgenville, KY

ERIC ALLEN - Missions Mobilization Team Leader, Kentucky Baptist Convention, Louisville, KY

JON AUTEN - Missions Consultant, Kentucky WMU, Jeffersontown, KY

PAT CALLAN - Vice - President, Kentucky WMU, Sparta, KY

CLAUDIA GREENWOOD - Nominating Committee Chair, Kentucky WMU, Gray, KY

PEGGY MERIEDETH - Board Member, Four Rivers Mental Health, Barlow, KY

STACY NALL - Missions Consultant, Kentucky WMU, Shelbyville, KY

TERESA PARRETT - Missions Mobilization Coordinator, Kentucky Baptist Convention, Somerset, KY

LORI SHARP - Financial Coordinator, Kentucky WMU, Louisville, KY

Workshop SPEAKERS

Rob Allen - NAMB Send Relief, Appalachia Ministry Center, Ashland, KY

Penny Akers - Executive Board Member, Kentucky WMU, Elizabethtown, KY

Jon Auten - Missions Consultant, Kentucky WMU, Jeffersontown, KY

John Barnett - Missions Mobilization Consultant, Kentucky Baptist Convention, Louisville, KY

Taryn Blocker - Graduate Student, The Southern Baptist Theological Seminary, Louisville, KY

Susan Bryant - Former President, Kentucky WMU, Graefenburg Baptist Church, Pleasureville, KY

Dawna Clark - Central Baptist Church Lawrenceburg, Waddy, KY

Cassie Couch - Executive Board Member, Kentucky WMU, Corbin, KY

Liz Encinia - Executive Director-Treasurer, Kentucky WMU, Louisville, KY

Jessica Gray - Staff Assistant, Kentucky BCM, Morehead, KY

Job Juarez - Church Planting Group Leader & Development Associate, Kentucky Baptist Convention, Shelbyville, KY

Andy McDonald - Regional Consultant, Kentucky Baptist Convention, Shelbyville, KY

Stacy Nall - Missions Consultant, Kentucky WMU, Shelbyville, KY

Darcy Jo Porter - Executive Board Member, Kentucky WMU, Paintsville, KY

Dawn Reed - Kentucky Today Columnist, Fitzpatrick First Baptist Church, Prestonsburg, KY

Lee Rust - KY MSC Missionary, Freedom Forever Ministries, Paducah, KY

Mark Sickling - Disaster Relief Representative, KY

Charity Taylor - Shelbyville First Baptist Church, Shelbyville, KY

Jeff Wallace - Minister of Global Outreach/55+, Lone Oak First Baptist Church, Paducah, KY

THE *Marketplace:* MINISTRY PARTNERS

The Marketplace offers a variety of ministry partners and opportunities to help you Learn about, Pray for, Give to, and Engage in... missions. The Kentucky WMU exhibit offers various resources to help you strengthen missions discipleship, leadership development, and compassion ministries in your church. WorldCrafts provides an opportunity to purchase fair trade items and support artisans around the world. There is something for everyone!

The Marketplace is located in the Gym.

MINISTRY PARTNERS REPRESENTED

COOPERATIVE PROGRAM
INTERNATIONAL MISSION BOARD
SEND RELIEF
KBC MISSIONS MOBILIZATION
KENTUCKY BAPTIST CAMPUS MINISTRY
KENTUCKY BAPTIST FOUNDATION
KENTUCKY CHANGERS
KENTUCKY WMU
NATIONAL BNF
ONEIDA
SONRISE CHILDREN'S SERVICES
WORLDCRAFTS MARKET

MISSIONARY Prayer CALENDAR

APRIL 8, 2022

NORTH AMERICAN MISSION BOARD

Florida: Issac Todd

Georgia: Justin Ely

Mississippi: Scott Fortenberry

New York: Devon Bartholomew

INTERNATIONAL MISSION BOARD

American Peoples: Jacob Glover, Jesse Koch

Asian Pacific Rim Peoples: JG, Andrew Morris

Central Asian Peoples: JF, MK, BP

European Peoples: GT

CHAPLAINS • VOLUNTEERS

STATE CONVENTION MISSIONARIES

RETIRED

NAMB: Ursula Liburd, Leonard Morgan,

IMB: Liz Corwin, Janice Day, Dwight Fern, DG, Dottie Gray, Ganelle Hampton, Judy Hawkins

NORTH AMERICAN MISSION BOARD

Florida: Gerardo Lopez

Illinois: Wei Gao

Missouri: Arnaldo Achucarro, Gene Collins

New Jersey: Victor Pulido

New York: Jordan Saucedo

North Carolina: Alphonso Gonah

Oklahoma: Matthew Beasley

INTERNATIONAL MISSION BOARD

American Peoples: Kandi Ostertag

Asian Pacific Rim Peoples: Kayo Borg, MW, Carlton Walker

Central Asian Peoples: MB, SH

European Peoples: Christopher Przybylowicz

CHAPLAINS • VOLUNTEERS

STATE CONVENTION MISSIONARIES

RETIRED

NAMB: Joycelyn Carrell, Mary Diaz, Evelyn Foote

IMB: Mary Donahoe, Kaye Martin, Brian Petersen, Suzie Plunk

APRIL 9, 2022

Supporting OUR MISSIONARIES

Kentucky WMU created an opportunity to support international missionaries who call Kentucky home.

- Christmas gifts of \$50 to international missionaries whose home state is Kentucky
- MK Gifts of \$100 each fall and spring are provided for children of Kentucky international career missionaries enrolled in Kentucky colleges
- Gifts of \$100 to new career international missionary appointees from Kentucky
- Missionary Parents Fellowship gatherings
- Missionary Kid Re-Entry Retreat

These ministries are funded through a special offering taken at the Kentucky WMU Annual Meeting.

**HOW MUCH WILL
YOU GIVE TO HELP
REACH THIS YEAR'S
OFFERING GOAL?**

**OUR GOAL:
\$8,000**

“Thank You FROM OUR MISSIONARIES

We could not do what we do without your vital work. Thank you for the generous gift!
What a blessing to have such support in so many ways. I'm grateful for you all and
thankful for your partnership in the gospel.---RM, Asian Pacific Rim

Tom and I were privileged to volunteer in Charlotte, North Carolina at the processing
center for Christmas shoeboxes. We used the Kentucky Christmas gifts toward the cost
of that mission trip. Thanks so much for blessing us this way each year.
---Tom and Phyllis Baker, IMB Emeritus

I'm so grateful for the care and support you've shown me and my family the past two
decades. Thank you for your faithful Christmas gifts every year- a special blessing every
time.---D & M, NAME

Thank you so much for the \$50. You are so kind and generous. We appreciate all you at
Kentucky WMU do for the worldwide kingdom. ---Jerry and Carol Robertson, IMB
Emeritus

We can't say how much we appreciate the Christmas gift Kentucky WMU so graciously
sends us each year. We are ever so grateful and will forever remember how blessed we
are to have been a part of Kentucky Baptists. We miss living in Kentucky, but God had
other plans for our lives.---Bob and Oakie Blevins, IMB Emeritus

Thank you so much for the gift. You all are such a blessing to us Kentucky missionaries,
and to so many folks in many places.---Charles Love

”

KBC MISSIONARY *Commissioning*

Kentucky Mission Service Corps missionaries are adults (18 years of age or older), called by God and connected to a Kentucky Baptist Convention church. The missionaries are self-funded and serve in positions that engage in or directly support missions, church planting, collegiate ministry, or evangelism, in cooperative partnership with a Kentucky Baptist Convention church, association, or organization.

Please commit to pray for and support these our newest KY-MSC missionaries as they serve.

Use the interSEED prayer calendar (www.kybaptist.org/interseed) to pray for the KY-MSC Missionaries on their birthdays.



MOLLIE BENTLEY

Rockhouse Baptist Church
Mission Center, Hyden



PERRY COOKE

Mark 12 Ministries,
Louisville



MARILYN CREIGHTON

KBC North-Central Region
Mobilization Consultant, Lexington



VIRGINIA DIAL

Connect Community
Village, Somerset



DAVID LITTLE

Arlene - Western Kentucky
Correctional Complex Prison
Ministry, Fredonia



**DARYL & SHEILA
MULLINS**

The Haven at Clarity,
Elizabethtown



PAM POLKEY

Irishtown Ministries, Lexington



**BRYAN & STEPHANIE
PROCTOR**

Orphan Care Alliance,
Lawrenceburg



ROBERTA ROBINSON

Bright Life Farms,
Princeton



REBECCA SALYER

The Branch Church Plant,
Prestonsburg



MJ SCHOPP

Kentucky Joy in the
Mourning, Burlington



**JERRY & KIMBERLY
WALLACE**

Northern Kentucky Re-
entry, Cold Spring

To learn more about our KY-MSC Missionaries go to www.kybaptist.org/missionaries.
Adopt one of our KY-MSC Missionaries through the Adopt-a-Missionary program. Go to
www.kybaptist.org/adoptmissionary.

2022 KENTUCKY *Missionary* OF THE YEAR



Introducing the 2022 Kentucky Missionary of the Year

Stacey Burton, Director of Lake Cumberland Baptist Association's PM59 Ministries in Somerset, is the 2022 Kentucky Missionary of the Year.

Stacey has served as a Mission Service Corps Missionary since June 2013. She directs a ministry to children and families which, in the past, has included a children's choir, family mission action projects, mission education for children, day camps, family movie nights, and much more.

In March 2020, when the pandemic forced their regular ministry activities to stop, Stacey found new adventures and new ways to reach her community. Working with five partnering churches, they began drive-thru dinners and, when these stopped, she focused on two housing areas where they continued to deliver meals.

Stacey ministers to ladies at a local rehab center, where she builds relationships, feeds them meals, and offers encouragement. Over the past couple of years, she has seen many of these ladies profess faith in Christ and follow through with baptism. Stacey helps to connect them to a local church and continues to disciple them in their new walk with the Lord.

On her 2021 KY-MSC ministry report, Stacey reported thirty professions of faith and twenty-five baptisms as a result of her ministry and/or personal witnessing.

Each year Stacey coordinates the Christmas Backpack program in Pulaski County, serving nearly one thousand local children. She works with other churches in the Lake Cumberland Baptist Association to create, organize, and/or maintain their preschool, children, and family ministries, and helps many of the smaller churches with Vacation Bible School.

Stacey left a career as a public-school teacher a few years ago to devote full-time to this ministry position. In addition to her ministry, she has adopted and fostered several children, some of which are now teenagers, and is leading them to be active in ministry.

Bro. Ed Amundson, Stacey's pastor at High Street Baptist Church in Somerset, has shared how valuable Stacey has been in leading their church and other churches in the Lake Cumberland Baptist Association to be on-mission in their local communities.

Stacey is most deserving of this award, which is given annually to a missionary that demonstrates:

- Commitment to and effectiveness in evangelism, church planting, or ministry.
- Demonstration of "going the second mile."
- Outstanding performance in achieving assigned tasks.
- Tenure
- Unusual commitment to our Lord's service.
- Positive representation of the Kentucky Baptist Convention.
- True reflection of being an "On Mission Christian."

CONGRATULATIONS, Stacey!!

2022 KENTUCKY
Missionary
OF THE YEAR



Thank you

The Kentucky WMU Missions Celebration and Annual Meeting would not be possible without the help of many people. A huge thanks this year goes out to:

CHURCHES

- that give through the Cooperative Program and the Eliza Broadus Offering for State Missions; without your support, none of this would be possible.

FIRST BAPTIST CHURCH, HODGENVILLE

- for the use of your beautiful facility and all the assistance you provided in getting ready for this event.

KENTUCKY WMU EXECUTIVE BOARD & STAFF

- for your prayers, encouragement, participation, and service this weekend. A true team effort!

EXHIBITORS & MINISTRY PARTNERS

- for opening our eyes, hearts, and minds to opportunities to serve in Christ's name in our local communities, in Kentucky, and beyond.

LOCAL ARRANGEMENTS TEAM & VOLUNTEERS

- for the many ways you served to make this experience all it could be.

PROGRAM GUESTS, MISSIONARIES, & CONFERENCE LEADERS

- for providing information, ideas, and practical ways to engage the world for the Gospel of Jesus Christ.

Announcements

SPECIAL OFFERING

Each year, we take up a special offering called Ministries to Missionaries. This offering provides a Christmas gift to international missionaries whose home state is Kentucky, MK gifts for children of Kentucky international career missionaries enrolled in Kentucky colleges, gifts to new career missionary appointments from Kentucky, membership to the Missionary Parents Fellowship, and covers travel costs for MKs attending the MK re-entry retreat. You will have the opportunity to give during each general session. Our goal for this offering is \$8,000.

You can give in person or online at www.kywmu.org/waystogive.

HEALTH & SAFETY

COVID Safety & First Aid- Masks are optional for the duration of this weekend's event. Please remember to wash your hands frequently throughout the day and social distance if desired. If medical attention is needed, please see someone at the registration desk.

INSURANCE

Limited accident insurance is provided for registered attendees while at the annual meeting. If an accident occurs, please go to the registration table and ask for a Kentucky WMU staff member to assist you. Following the meeting, contact Lori Sharp, 13420 Eastpoint Centre Dr, Louisville, KY 40223, 502.489.3534.

WATER AND SNACK SERVICE

Snack stations are located near the conference rooms.

PHOTOS

Please take photos and enjoy your time at Annual Meeting. If you are posting on Social Media please, use the hashtag #kywmu2022 with your photos. Also, please consider the safety of our IMB missionaries. We have one missionary couple that is classified as level 3. Please DO NOT post their photos online or use their names online.

Experiences

THE MARKETPLACE

Visit The Marketplace in the Gym. This area will be open throughout the meeting. Explore ministries and services that might be useful to you and your church. Engage with ministries and missionaries and learn how you can get involved. The Marketplace is open throughout the annual meeting except for the general sessions. You are welcome to spend time in The Marketplace as an alternate option during the workshop sessions.

WORLDCRAFTS STORE AND DISPLACED: SEEKING HOME SIMULATION

Who doesn't love to shop? Visit the WorldCrafts store in The Marketplace. You will also find the Displaced: Seeking Home simulation which provides participants a glimpse into some of the difficult decisions and struggles refugees and displaced people in the United States experience as they go through the difficult resettlement process.

MEALS

Meals are on your own. However, Hodgenville has lots of wonderful restaurants nearby. Make it a point to share the Gospel as you are out and about. Enjoy!

MINISTRY PROJECT - WELCOME BASKETS

We are encouraging Kentucky Baptists to be good hosts and gather welcome baskets for refugees, individuals, and families resettling to our area. If you brought your welcome basket with you to Annual Meeting, please drop it off in the Marketplace. If you haven't collected your items, there is still time over this weekend to gather your items and make a donation. Basket information and content list may be found at the Ministry Project booth in the Gym.

Kentucky WMU, Inc. Bylaws

PART 1

ARTICLE I

Membership and Voting

Voting

INFORMATION

Section 1. Kentucky Woman's Missionary Union is comprised of the membership of WMU organizations in Kentucky Baptist Churches in cooperation with the Kentucky Baptist Convention.

As amended April 5, 2019

Section 2. Only members of local church WMU organizations may vote at meetings of Kentucky WMU.

ARTICLE III

Meetings of Members

Section 5. Kentucky Woman's Missionary Union members present in any session of an Annual or special meeting shall constitute the voting body. No proxy or cumulative voting shall exist.

Section 6. A quorum shall consist of a majority of the registered members.

ARTICLE IV

Executive Board

Section 1. The Executive Board shall be the board of directors of the corporation. Thirty persons shall constitute the Executive Board: the three officers, not including the Executive Director-Treasurer, three members from each of the eight geographical areas, a Royal Ambassadors/Challengers Representative appointed by the President to serve a term of up to three years, and by virtue of their offices, the President of the Baptist Nursing Fellowship and the Development Specialist.

As amended March 23, 2012

The members representing the geographical areas shall be nominated by the Nominating Committee and elected by the members in the annual meeting. Nominations may also be made from the floor.

1. A geographical area member shall be elected for a term of one year from annual meeting to annual meeting. She shall be eligible to serve a total of three full consecutive one year terms, except as provided in the following paragraph. Thereafter, she shall not be eligible for election to the Board until one year has elapsed from the last day of her service as a member of the Board.

As amended April 5, 2019

1. One Executive Board member from each area shall rotate off the Board each year. If a member is not subsequently elected to each of the three terms for which she is eligible, the person elected in her stead shall be eligible for reelection to additional consecutive terms according to the eligibility of her predecessor in office, thus maintaining the rotation.

1. In the event a vacancy occurs in an area position on the Board between Annual Meetings, the President may, in consultation with the Executive Director-Treasurer and the chairwoman of the Nominating Committee, appoint a person to fill the unexpired portion of the one year term.

ARTICLE VI

Parliamentary Authority

Kentucky Woman's Missionary Union shall use as its parliamentary authority Robert's Rules of Order, Revised.

Executive Board Nominee Recommendation

Submit one form per nominee. Duplicate form as needed.

KentuckyWMU

Kentucky Woman's Missionary Union

PLEASE PRINT LEGIBLY • PLEASE PRINT LEGIBLY • PLEASE PRINT LEGIBLY

I recommend _____ for consideration as a nominee for:
(Print Name of Nominee)

☐ WMU Regional Executive Board Member

To be eligible for election as a regional board member, a nominee **MUST**:

1. Possess a thorough knowledge of Woman's Missionary Union, its organizations and ministries, through personal involvement in a Kentucky Baptist Convention church and association.
2. Be available to attend Executive Board meetings, committee meetings and the Annual Meeting of Kentucky WMU.
3. Not be an employee of Kentucky WMU or the family member of an employee.

☐ WMU Officer (Nominee **MUST** have served on Executive Board to be eligible to hold office.)

Nominee Information	Church-Related Information
Address _____	Nominee's Church _____
City/State /Zip Code _____	Pastor _____
Email _____	Address _____
Phone (_____) _____	City/State/Zip _____
Occupation _____	WMU Director _____
Approximate Age _____	Address _____
	City/State/Zip _____

List Current Leadership Positions Nominee Holds:

Church	Association	Denominational (State or National)

This Section to be Completed by Person Making Recommendation

I have observed and/or worked with this person in these situations (e.g., ministry involvement, WMU leadership):

I acknowledge that my recommendation does not guarantee nomination by the Kentucky WMU Nominating Committee and/or election by Kentucky WMU. However, I understand that my recommendation will be given serious consideration and that if selected, the Nominating Committee will secure her consent to serve in the capacity I've recommended.

Signature _____ Date _____

Print Name _____

Address _____

City/State/Zip _____

Email _____

Phone (_____) _____

Church _____ Association _____

Mail recommendations to: **Kentucky WMU, 13420 Eastpoint Centre Dr., Louisville, KY 40233**

**KENTUCKY WOMAN'S MISSIONARY UNION
MISSIONS CELEBRATION AND 118TH ANNUAL MEETING
FIRST BAPTIST CHURCH, SHELBYVILLE
APRIL 16-17, 2021**

SATURDAY MORNING, APRIL 17, 2021, BUSINESS SESSION

CALL TO ORDER

Roetta Vaught, President, called the Business Session to order.

APPROVAL OF MINUTES FROM 2019 KENTUCKY WMU ANNUAL MEETING

A motion was made by Melissa Logsdon-Young with a second by Sharon Taylor-Carrillo to approve the minutes of the 2019 Kentucky WMU Annual Meeting as printed. Motion carried.

There were no minutes from the 2020 Kentucky WMU Annual Meeting which was provided as an online virtual experience with no business session.

NOMINATING COMMITTEE REPORT AND ELECTION OF OFFICERS AND EXECUTIVE BOARD

Roetta Vaught presided over the election of officers and board members. Edwina Rowell, chair of the Nominating Committee, presented the committee's recommendations.

Pat Callan, Vice President, served as the presiding officer during the election of the President. Roetta Vaught was recommended to serve as President for 2021-22. There were no nominations from the floor. Motion carried.

Roetta Vaught resumed the role of presiding officer. The Nominating Committee recommended Pat Callan to serve as Vice President. Edwina stated that in the event the office of President becomes vacant between Annual Meetings, or for any reason the President is unable to serve, the Vice President shall fill the office of President until the next Annual Meeting. This provision shall be stated verbally at the time of the election of the Vice-President. There were no nominations from the floor. Motion carried.

Melissa Logsdon-Young was nominated to serve as Recording Secretary. There were no nominations from the floor. Motion carried.

The Nominating Committee recommends the following members to serve on the Kentucky WMU Executive Board for 2021-2022 as Regional members:

Region 1 – Connie Rodgers, Gayla Hill; Dianne McNichols
Region 2 – Beth Britto, Diane Thacker; Brenda McKinney
Region 3 – Amy Cardwell, Sharon Givens; Penny Akers
Region 4 – Libby Thomas, Rebecca Dabney; Vandana Aghamkar
Region 5 – Karin Edgington, Jean Morgan; Benita Decker
Region 6 – Linda Devine, Sherry Hendrix; Dianne Smith
Region 7 – Edwina Rowell, Cassie Couch, Teresa Vanzant
Region 8 – Linda Booth, Claudia Greenwood, Darcy Jo Porter

Also note that appointed by the President: David Buie will serve as a board member representing Royal Ambassadors/Challengers and Cathy Chinn, as Development Specialist.

There were no nominations from the floor. Motion carried.

INSTALLATION OF OFFICERS AND BOARD

Susan Bryant, former President of Kentucky WMU, gave a challenge to the newly-elected board and prayed for them. Susan emphasized the importance of the work that the board will do and the eternal significance it will have.

EXECUTIVE DIRECTOR-TREASURER AND PRESIDENT REPORT

Liz Encinia, Executive Director-Treasurer of Kentucky WMU, and Roetta Vaught, President of Kentucky WMU, presented their report to attendees. They reviewed how Kentucky WMU had continued to provide experiences and encouragement to learn, pray, give, and go during the Covid-19 pandemic. The 2020 Kentucky WMU Missions Celebration and Annual Meeting was offered as an online virtual experience since safety measures in response to the pandemic prevented large groups from gathering in person. Other online experiences such as camp, Women on Mission meetings, GA JAM, etc. followed throughout the year.

They shared some changes at the national WMU level, including a decision to sell the current building owned by National WMU in order to downsize for a more affordable working space. Also, National WMU is launching a new curriculum, Missions Journey: Kids, for children in Grades 1-6. This curriculum will replace the current offerings for Girls in Action, Royal Ambassadors, and Children in Action. Missions Journey: Kids may be used by any of these mission education groups as well as be incorporated into other children's discipleship groups.

Kentucky WMU also worked with Indiana WMU to offer the MK Re-entry Retreat, an important experience for Missionary Kids who are returning to the United States from international places of service to attend college. The retreat gives the students an opportunity reacclimate to the U.S. culture as they begin college.

Liz and Roetta reminded us through their report that "the mission matters most." We cannot let things like pandemics, financial struggles, or anything else keep us from fulfilling God's plan.

Roetta Vaught closed the business session.

Respectfully submitted,

Marcia Ballard
Recording Secretary
Kentucky WMU

2022 KY WMU
Mission
OPPORTUNITIES
AT A GLANCE

April

29-30 Children's Missions Leaders Retreat

May

14 Kentucky WMU Executive Board Orientation, KBC, Louisville
21 SALT: State Associational Leadership Training (5 locations, TBA)

June

4 Explore, Lost River Cave, Bowling Green, KY
12-13 National WMU Missions Celebration and Annual Meeting, Anaheim, CA
14-15 Southern Baptist Convention, Anaheim, CA
16-18 Changers Kids, Lowell Avenue Baptist Church, Campbellsville
18-24 Kentucky Changers, Somerset
25-7/1 Kentucky Changers, Owensboro
27-30 Mission Adventure Camp, Clear Creek Baptist College, Pineville, KY

July

9-15 Kentucky Changers, Shelbyville

August

16 Equip Tour
18 Equip Tour
23 Equip Tour
25 Equip Tour
27 Hunger Awareness Day
30 Equip Tour

September

1 Equip Tour
6 Equip Tour
8 Equip Tour
13 Equip Tour
15 Equip Tour
11-18 State Missions Emphasis and Eliza Broadus Offering
17 Children's Missions Day
24-16 Fall Adult Changers Missions Trip

October

14-15 Fall Women's Retreat, Barefoot Republic Retreat Center, Fountain Run, KY
27-29 Kentucky WMU Executive Board Meeting, KBC, Louisville

November

7 Baptist Women's World Day of Prayer
5 GA JAM: Jesus and Missions (location tba)
9-10 Kentucky Baptist Convention Annual Meeting

December

4-11 International Missions Emphasis and Lottie Moon Christmas Offering

Stay connected for event updates and more information at:

www.kywmu.org

www.facebook.com/kywmu



Katelyn Hicks

2021-2022 STATE ACTEENS PANELIST

Unity Baptist Church, Ashland

Thank you, for serving this year!



Notes

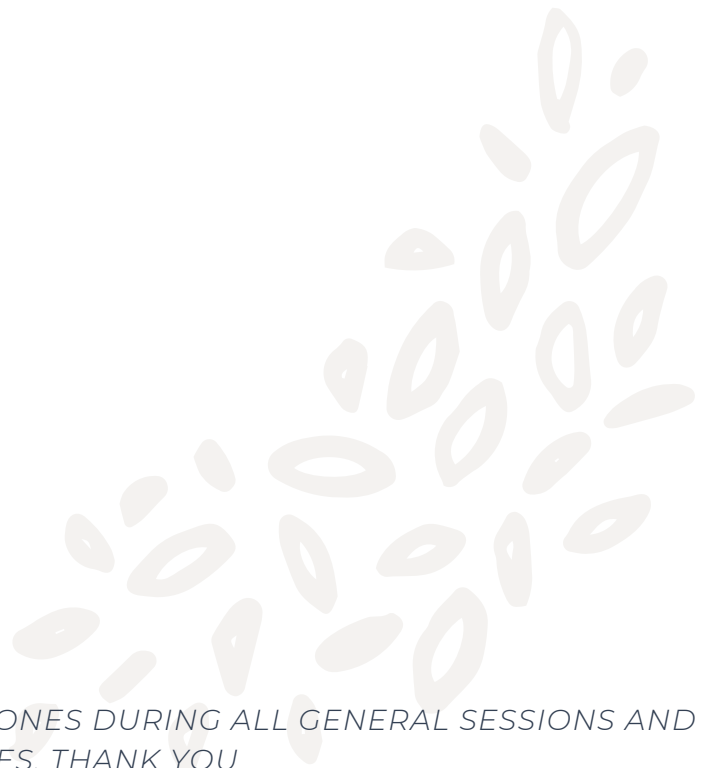

PLEASE REMEMBER TO SILENCE CELL PHONES DURING ALL GENERAL SESSIONS AND
CONFERENCES. THANK YOU



READY CHURCH

PREPARE > CONNECT > RESPOND

Help your church *prepare, connect* and *respond* in times of crisis and disaster.

Visit kybaptist.org/readychurch

For more information, contact Ron Crow, Disaster Relief Director



502-489-3401



ron.crow@kybaptist.org



DISASTER RELIEF TRAINING 2022

MARCH 19

Chaplaincy Training March 18-19

Owensboro

APRIL 9

Chaplaincy Training April 8-9

Winchester

SEPTEMBER 10

Chaplaincy Training September 9-10

Waddy

OCTOBER 8

Chaplaincy Training October 7-8

London

BE PREPARED *to make a difference*

Visit kybaptist.org/dr or call 502-489-3527

Notes

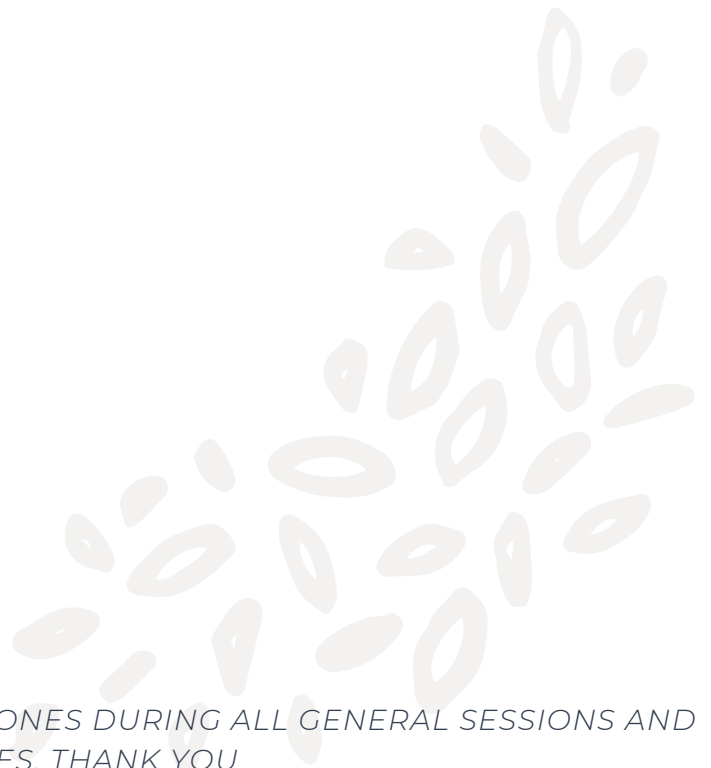

PLEASE REMEMBER TO SILENCE CELL PHONES DURING ALL GENERAL SESSIONS AND
CONFERENCES. THANK YOU

EVANGELISM



ROB PATTERSON
Evangelism Team Leader
606-765-9176
Rob.Patterson@kybaptist.org



IAN CARRICO
Church Evangelism Associate
270-562-1196
Ian.Carrico@kybaptist.org



KENNY RAGER
Church Evangelism Strategist
270-314-2060
Kenny.Rager@kybaptist.org

CHURCH PLANTING



TOBY DEHAY
Church Planting &
Development Associate
270-621-0354
Toby.DeHay@kybaptist.org



JOB JUAREZ
Church Planting Group Leader &
Development Associate
502-295-7659
Job.Juarez@kybaptist.org



EDDIE TORRES
Multi Language Planting &
Development Associate
502-640-8747
Eddie.Torres@kybaptist.org

MINISTRY ASSISTANTS



DEANNA TERRY
Team Ministry
Assistant
502-489-3418
Deanna.Terry@kybaptist.org



DAWN CAVANAH
Church Planting
Ministry Assistant
502-489-3408
Dawn.Cavanah@kybaptist.org



JONAH PACK
Campus Ministry
Assistant
502-489-3345
Jonah.Pack@kybaptist.org

CHURCH PLANTING & CAMPUS MINISTRY



CARLOS DE LA BARRA
Church Planting Strategist &
Campus Ministry Director
502-489-3419
Carlos.DelaBarra@kybaptist.org

REGIONAL CAMPUS MINISTERS



JONATHAN CLARK
Murray Region
BCM: 270-753-5771
Cell: 985-687-9488
Jonathan.Clark@kybaptist.org



JAKE HANCOCK
Richmond Region
BCM: 859-623-3294
Cell: 270-217-6434
Jake.Hancock@kybaptist.org



BRIAN HINTON
Louisville Region
BCM: 502-852-6595
Cell: 859-396-0874
Brian.Hinton@kybaptist.org



DANIEL JOHNSON
Lexington Region
BCM: 859-469-9709
Cell: 912-682-1416
Daniel.Johnson@kybaptist.org



TOMMY JOHNSON
Regional Campus Minister Group
Leader - Bowling Green Region
BCM: 270-781-3185
Cell: 270-779-9929
Tommy.Johnson@kybaptist.org



MATTHEW MOFIELD
Morehead Region
BCM: 606-784-4490
Cell: 606-271-6974
Matthew.Mofield@kybaptist.org



JOSH SKIPPER
Northern Kentucky Region
BCM: 859-572-5955
Cell: 859-512-1428
Josh.Skipper@kybaptist.org



MARK WILLIAMS
Kentucky State University
(Interim)
BCM: 502-699-2674
Cell: 248-320-4620
Mark.Williams@kybaptist.org



EVANGELISM TEAM

“The Evangelism Team was created by churches for churches to help churches fulfill the “reach Kentucky” mandate of KBC’s larger mission statement. We help churches by encouraging evangelism through keeping lostness in view, equipping for personal and comprehensive evangelism, providing opportunities for engaging lostness, and expanding Kingdom impact through cooperative partnerships. The Lord has brought together an amazing team of evangelistic servants organized into three groups.

The Baptist campus ministry group helps students encounter Christ through engaging the local church.

The church planting group helps churches plant multiplying churches by partially funding but fully supporting church planting apprentices and church planters, as well as supporting multilingual ministries.

Be sure to check out the individual group reports to see how God is moving through the evangelistic cooperation of Kentucky Baptists.

– **ROB PATTERSON**
KBC Evangelism Team Leader

866-489-3418 (toll free)

KYBAPTIST.ORG/EVANGELISM

Notes

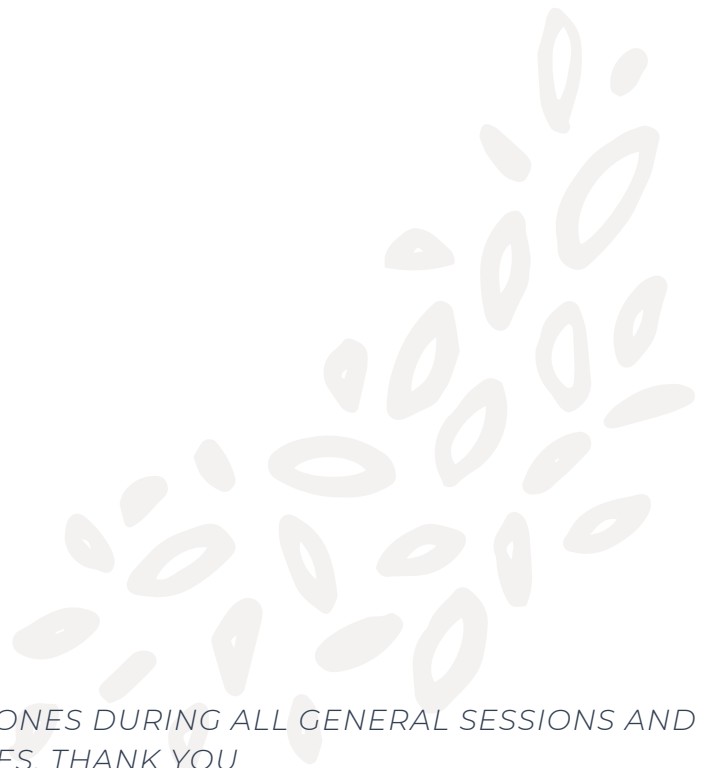

PLEASE REMEMBER TO SILENCE CELL PHONES DURING ALL GENERAL SESSIONS AND
CONFERENCES. THANK YOU

APRIL 28
London
Campbellsville

MAY 2
Hardin
Henderson

MAY 3
Winchester
Grayson

MAY 4
Louisville

RESET



EVANGELISM TRAINING



What will it take to RESET your church's evangelism strategy? As many churches turned inward and found it difficult to mobilize their people for evangelism during the pandemic, there were seemingly "pandemic proof" churches that experienced growth in baptisms, new ministries launched, and churches multiplied. What do the churches reaching Kentucky have in common? Come discover easily adaptable principles to RESET your church's evangelism strategy as you are encouraged by real-life examples of churches being used by God to REACH Kentucky.

APRIL 28

Noon-2:30 p.m. Corinth Baptist Church, London
6-8:30 p.m. South Campbellsville Baptist Church, Campbellsville

MAY 2

Noon-2:30 p.m. Blood River Baptist Association, Hardin
6-8:30 p.m. Green Valley Baptist Association, Henderson

MAY 3

Noon-2:30 p.m. Central Baptist Church, Winchester
6-8:30 p.m. First Baptist Church, Grayson

MAY 4

Noon-2:30 p.m. Kentucky Baptist Convention, Louisville

SPEAKERS

ROB PATTERSON
Kentucky Baptist Convention
Evangelism Team Leader

IAN CARRICO
Kentucky Baptist Convention
Church Evangelism Strategist

KENNY RAGER
Kentucky Baptist Convention
Church Evangelism Strategist

TO REGISTER: kybaptist.org/reset **NO COST!**

Start everyday with the Morning Briefing

FOLLOW US:



- TODAY'S TOP NEWS
- BAPTIST NEWS & FEATURES
- KENTUCKY SPORTS
- THOUGHTFUL COMMENTARY

**SIGN UP
TODAY!**

kentuckytoday.com/newsletter

KentuckyToday

REAL GOOD NEWS

KBFKENTUCKY BAPTIST
FOUNDATION

Short Term Fund

A *Great* Investment Strategy for Your Church or Ministry

The Kentucky Baptist Foundation is excited to offer the Short Term Fund (STF) as an investment option for churches and ministries looking for a low-risk investment alternative to traditional savings or money market accounts. The Short Term Fund offers a stable unit value unaffected by

market fluctuations. The STF is an actively managed, fully diversified investment portfolio designed to protect the principal investment while providing daily liquidity and a competitive return. Contact us to learn how this investment option can provide additional funds to your ministry.

**KBF**KENTUCKY BAPTIST
FOUNDATION

Funding the Great Commission

For more information **502-489-3533**
kybaptistfoundation.org/short-term-fund